

ORWAK 1100

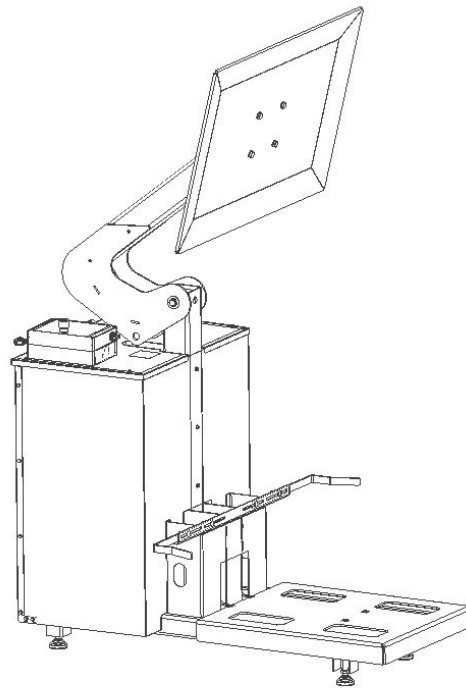

ORIGINAL OPERATING INSTRUCTIONS

CONTENTS

Safety information.....	12
Parts of the machine.....	13
Safety.....	14
Control panel.....	15
Installation.....	16
Operating instruction....	17
Weekly inspection and maintenance.....	17
Technical specification..	18
Dimensional drawing....	18
Transport.....	18
CE.....	19

Hydraulic diagram

Electrical diagram

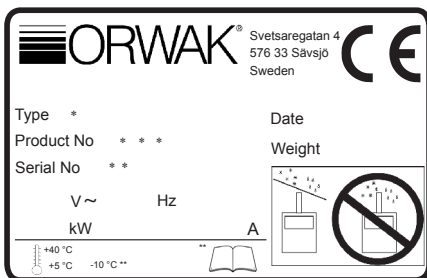

IDENTIFICATION

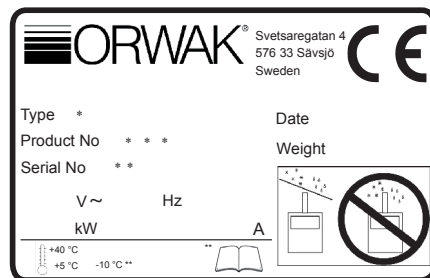

- * - XXXX (ex Compactor 1100)
- ** - XXXXXX (ex 161001)
- *** - 490XXXX - XXX (ex 4901100-00)

You find the serial number on the machine.
For any inquiries, please indicate the type and serial number of the machine.

English

OPERATOR WARNING & DUTY

This manual must be available permanently near the machine. Each operator must read and follow the full instruction of this manual before being authorize.

All operator must absolutely study and fully understand the operator's manual, specifically pay a particular attention to the safety procedure section.

In case of misunderstanding or doubt, do not start the machine. Contact support service.

Operators and service staff must comply by wearing personal protective equipment (PPE) before using or performing any maintenance operation following rule and regulation code.



Operator and service personal must be trained during the commissioning on the baler operation, by a duly authorized person from the manufacturer.

To avoid any mistake or accident, all operators must understand the operator manual.



All operators must absolutely study and fully understand the operator's manual. This manual must remain available for any personal involve with the machine.

SAFETY SIGN - In the manual



Warning !



During inspection and maintenance, servicing and removal of trapped waste. Disconnect the power to the machine by removing the plug from the wall socket.



Do not flush water on the machine.

SAFETY SIGN - On the machine



Danger High Voltage



Danger Risk of crushing

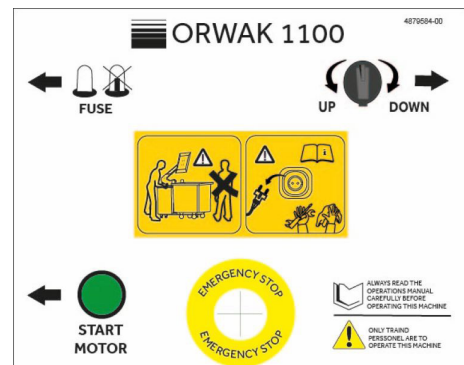

Electrical box

PARTS OF THE MACHINE

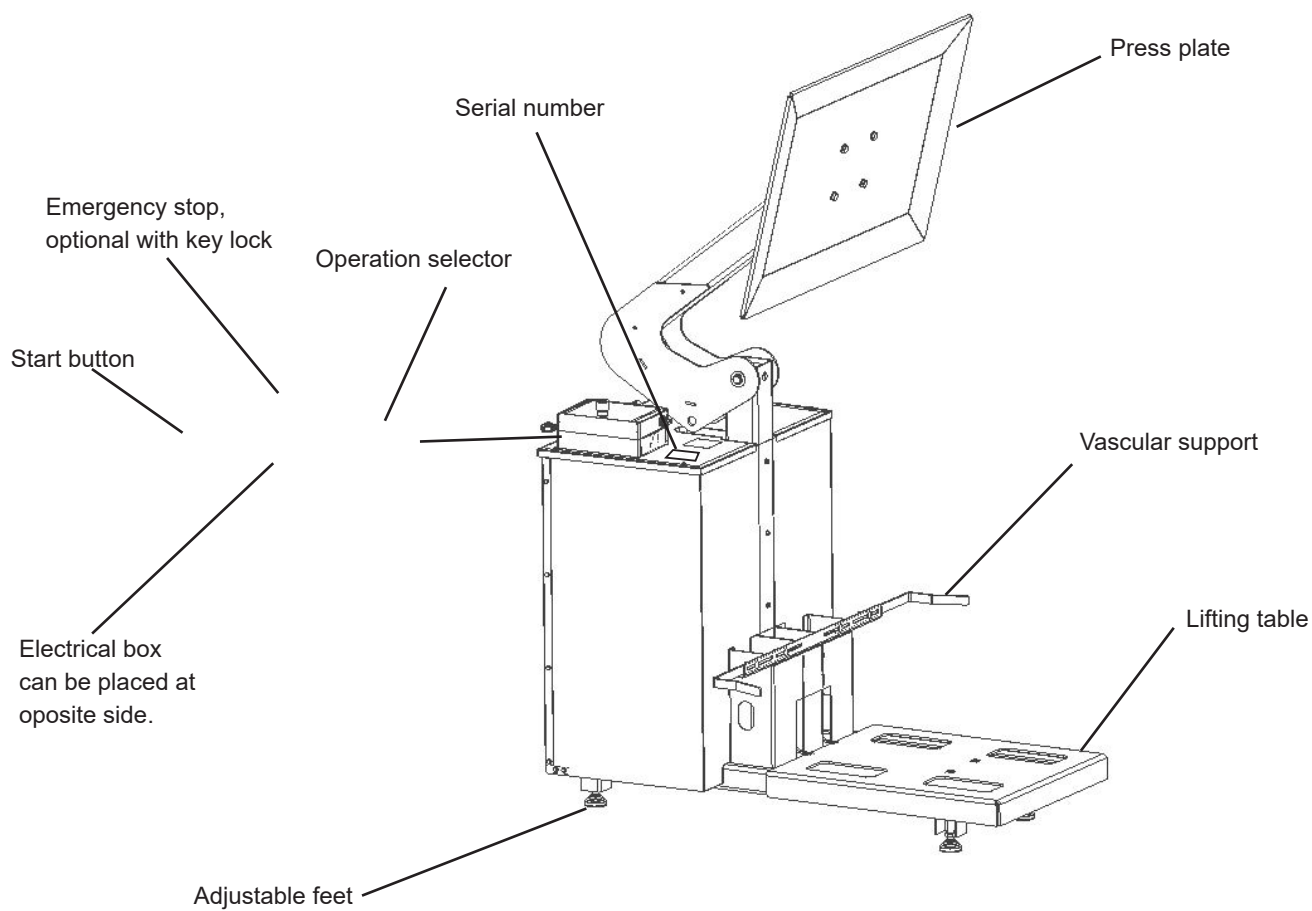

SAFETY

Please read the operating instructions **BEFORE** operating the machine.

Our warranty/product responsibility requires that:

- instructions are followed, and that no conversion or modification is carried out.
- original spare parts, and hydraulic oils and lubricants recommended by the machine manufacturer are used.
- at least one annual service is carried out.

The user of the machine is responsible for the safety checks, and for ensuring that daily maintenance of the machine is carried out.

The user is responsible for seeing to it that defects are rectified, and that neither the user nor other persons are exposed to danger.

The owner is responsible for ensuring that all laws and instructions are complied with when using the machine.



This symbol means WARNING or DANGER – personal safety instruction!



This machine is designed for **ONE-MAN OPERATION**.

Only the operator is allowed in the working area of the machine. The working area is defined under the heading **Technical data; Recommended space for machine in operation**. The operator must ensure that no one is in the area.



The machine must not be operated if the safety features (e.g. breakers and guards) have been deactivated, damaged or removed.



Lost or damaged parts must be replaced with **original spare parts**.



The machine may only be operated by a person who has received training and has experience of the machine.



The machine has a **high centre of gravity**. The press plate must be fully lowered when the machine is moved. The area immediately around the machine and its base should be completely level.



Installation, repair and servicing must only be performed by **qualified and competent** personnel, and in accordance with the installation and servicing instructions.



The machine **must not** be used by minors.



Avoid compacting materials of different hardness in the machine at the same time. (If the waste has not been properly mixed and distributed well in the bin, this can result in an uneven load on the press plate and damage to the machine).

SAFETY FEATURES

The machine is equipped with the following safety features:

Emergency stop, as well as **double command** to maneuver the machine.

The above-mentioned safety functions must be checked regularly, see the weekly inspection and maintenance section.

RANGE OF APPLICATION

The machine is a hydraulically operated baler intended for compacting bulky materials such as cardboard, paper and plastic. The machine may only be used in areas that have a roof, protection against wind, and normal lighting. The machine is intended for use within the temperature range -10°C to +40°C. A low-temperature oil and/or heater should be used at temperatures lower than +5°C.

Materials that are **flammable**, **corrosive** or of an **explosive** nature, such as pressurised containers or the like, which could cause injury, damage, fire or an explosion if exposed to pressure or sparks, **must not be** compacted in the machine.

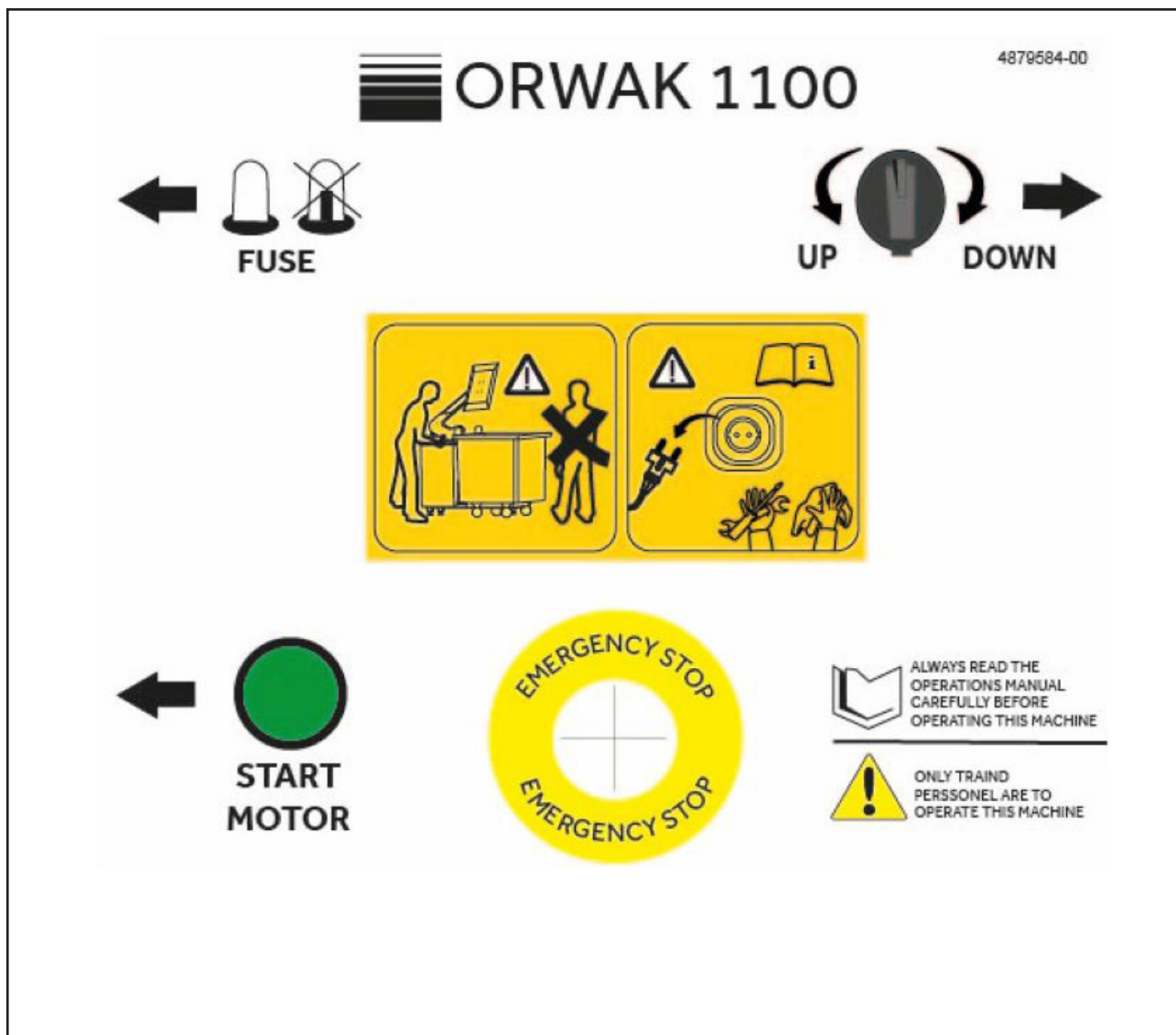

English

INSTALLATION

1. Remove the packaging.

2. Place the machine in the intended location and ensure that it is on a level surface with sufficient working space all around. Check that the ceiling height is sufficient. Plug in the machine. Make sure the cable is laid protected.

3. Raise the press plate, hold down the green button and keep the knob in the up position, until the press plate reaches its top position.

Then use a 13 mm wrench and loosen the nuts under the vessel supports. Roll the empty vessel onto the lifting table and center it. Make sure the press plate will not catch the sides of the vessel.

Then move the vessel supports to the sides of the vessel and tighten the nuts to ensure that the vessel supports do not move.

4. When compacting, the height of the feet may need to be adjusted up or down to ensure that all 4 wheels do not have contact with the ground during compaction. The machine has a standard setting on delivery, but must be adjusted during installation.

WARNING!
Only the operator is allowed in the working area of the machine!

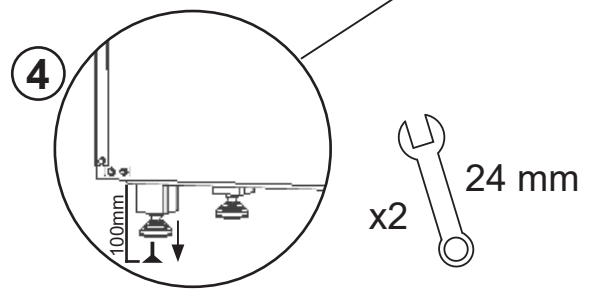
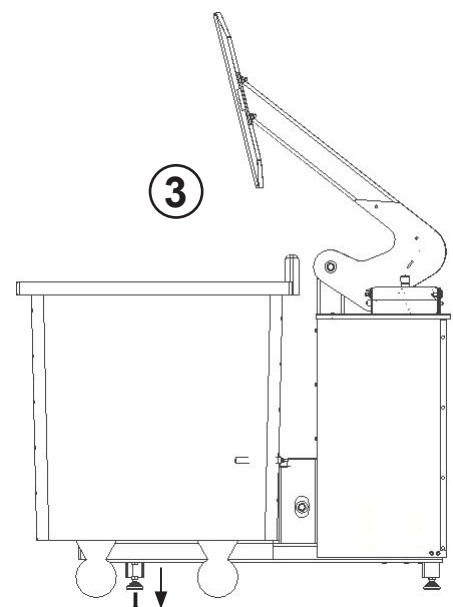
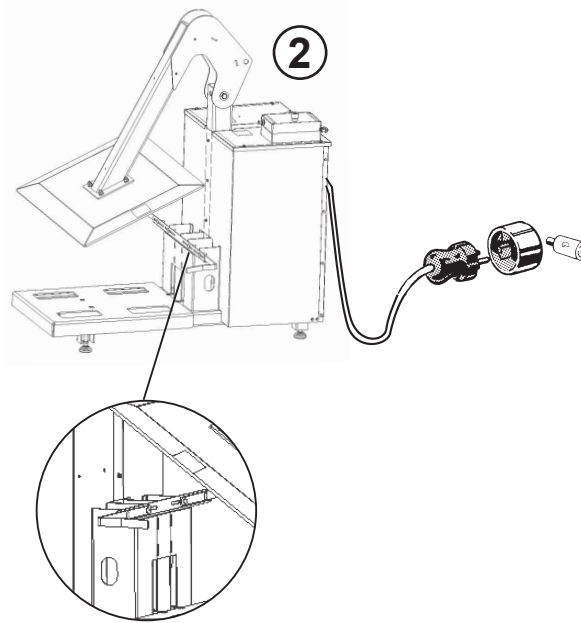
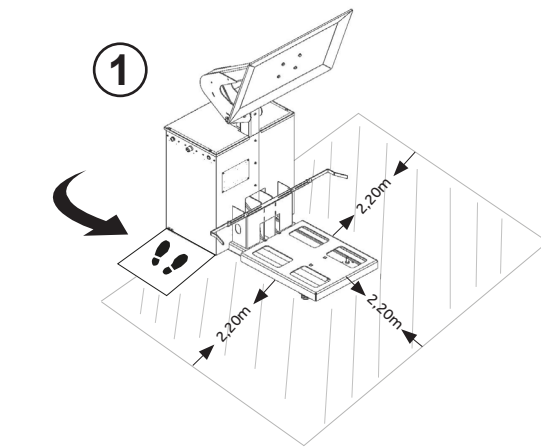

OPERATING INSTRUCTIONS

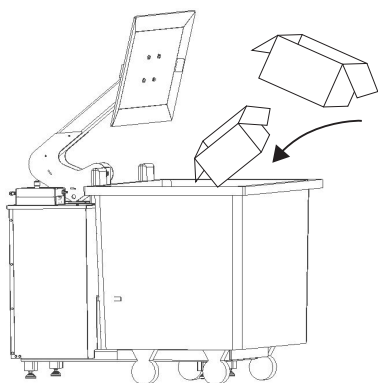

Place the bin and replenish materials.

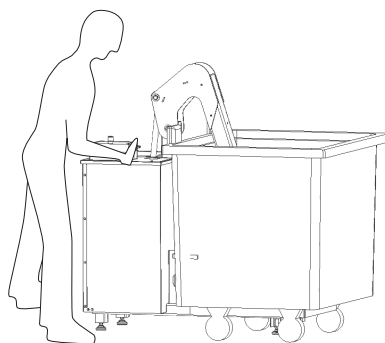

Press the material by lowering the press plate. Hold down the start button and turn the knob down. **ATTENTION!** Be aware that material can end up above the press plate when it is in the lowest position.

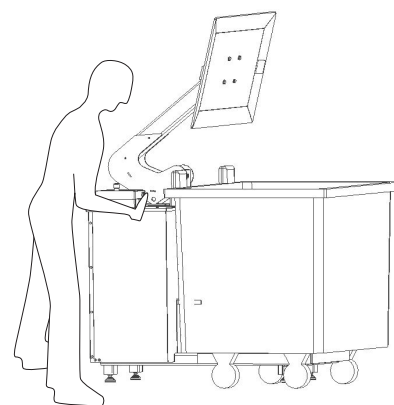

Raise the press plate to add more material.

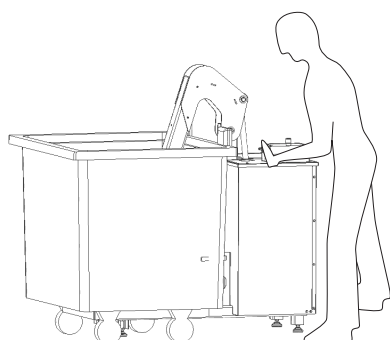

By moving the electrical box, the machine can be used on the opposite side.

WEEKLY INSPECTION AND MAINTENANCE



NOTE! During inspection and maintenance, servicing and the removal of trapped waste etc:
Disconnect the power to the machine by removing the plug from the wall socket.
Do not work inside the machine.

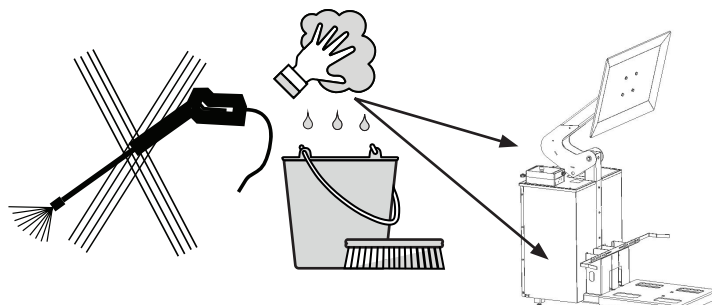

SAFETY CHECKS



- Check that the **emergency stop** is working.
- Check that all **covers and guards** are intact.
- Check that there are no oil leaks on the machine.
- Check that the electrical supply cable is intact and properly protected against impact.

If any faults are discovered in the functions listed above, the machine must not be used until it has been repaired by authorised service personnel.

Servicing and repairs must only be carried out by qualified and competent personnel, and in accordance with the machine manufacturer's instructions.



When changing the oil: Contact the local authorities for guidance regarding the environmentally correct disposal of waste oil. Miscibility must be taken into account when changing and/or topping up the oil. The machine comes filled with mineral oil from the factory.

English

TECHNICAL SPECIFICATIONS

GENERAL DATA

Total weight: 293 kg

Transport height: 1600 mm

Dimensions:

Mini working height: 1700 mm

Height (Pressplate up): 2080 mm

Height (Pressplate down): 1563 mm

Width: 1240 mm

Depth: 1378 mm

Recommended space for machine in operation (working area):

Height: 2180 mm

Width: 3200 mm

Depth with open door: 3000 mm

Noise level: 62 (± 1.0) dB (A)
(ISO 11200 & 11202)

Paint: Two-part paint and powder coat with phosphatising as base.

ELECTRICAL DATA

Operating power: 230V, 50Hz

Operating voltage: 24V

Electric motor: 1.1 kW

Fuse rating: 10 A

Protection class: 55 IP

HYDRAULIC DATA:

Working pressure: 80 bar

Overload pressure: 140 bar

Press force: 4 tons

Surface pressure: 1,15 kg/cm²

Cycle time, total: 44 s.

Cylinder stroke length: 300 mm

Oil volume: 7 litres

Recommended oil:
+5°C to +40°C

ISO VG 32-68, Mineral oil

Below +5°C

A special oil or heater should be used at lower temperatures.

DIMENSIONAL DIAGRAM

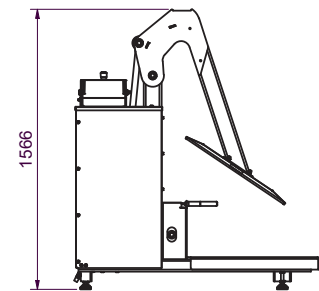
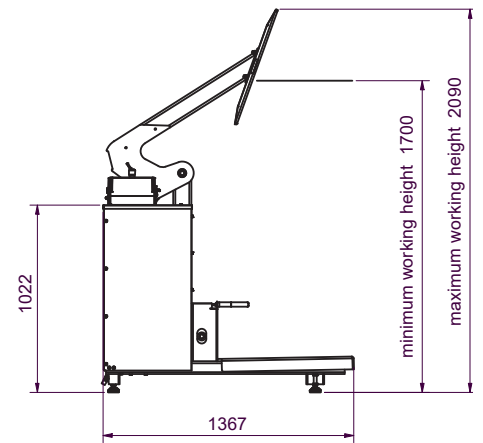
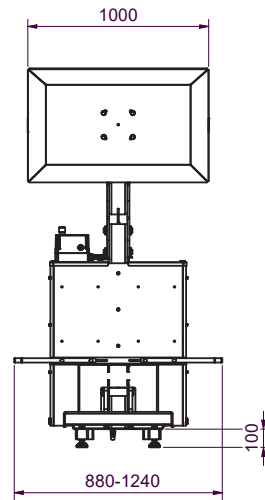

TRANSPORT

EC DECLARATION OF CONFORMITY



We Orwak AB
Svetsaregatan 4
SE-576 33 Sävsjö, Sweden
Tel: 46-382-15700

declare under our sole responsibility that the product model

4901100-00 - 4901100-100
4901100-S00 - 4901100-S100

to which this declaration relates is in conformity with the following standards or other normative documents in accordance with the provisions of Directives

2006/42/EEC (Machinery Directive)
2014/60/EU (EMC Directive)
2011/65/EU (RoHS II
with applicable supplements)

*The machine meets the requirements for PL = C
in accordance with EN ISO 13849-1*

EN 60204-1 (Safety of Machinery – Electrical Equipment of Machines)
EN 61000-6-1 (EMC Immunity for residential, commercial and light-industrial environments)
EN 61000-6-2 (EMC Immunity for industrial environments)
EN 61000-6-3 (EMC Emission standard for residential, commercial and light-industrial environments)
EN 61000-6-4 (EMC Emission standard for industrial environments)
EN ISO 13849-1 (Safety of Machinery – Safety-related parts of control systems)

Sävsjö 10.10.2024

A handwritten signature in blue ink, appearing to read "Philip Karlsson", with a horizontal line extending to the right.

Philip Karlsson

Compiler of technical documentation

HYDRAULIC DIAGRAM

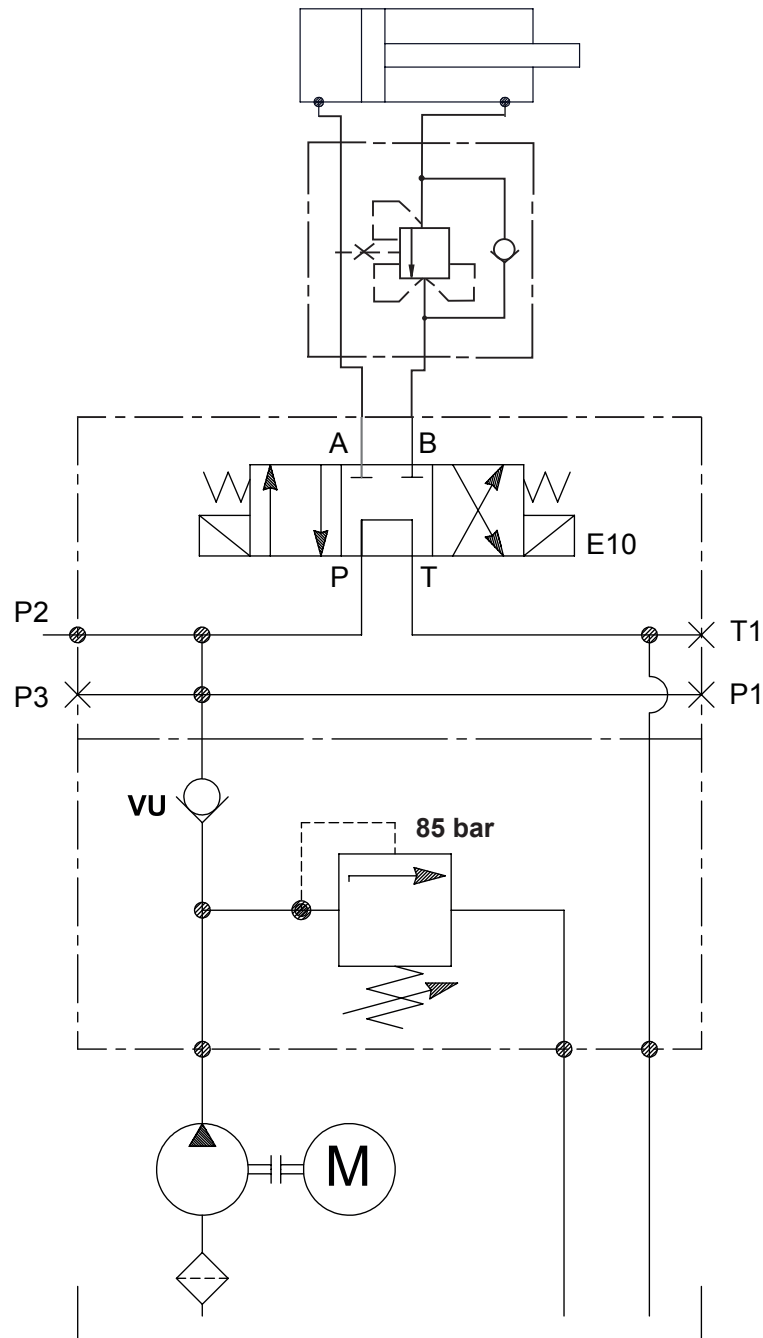

Item no.	Description Svenska
1	Elmotor
2	Pump
3	Sugfilter
4	Överströmsventil
5	Riktningsventil
6	Presscylinder
7	Lasthållningsventil

English	Deutsch	Français	Español
Electrical motor	Elektrischer Motor	Moteur électrique	Motor eléctrico
Pump	Pumpe	Pompe	Bomba
Suction filter	Saugsieb	Filtre	Filtro
Overload valve	Ventil	Soupape	Válvula
Directional valve	Richtungsventil	Soupape de direction	Válvula de dirección
Press cylinder	Presszylinder	Verin de compactage	Cilindro de compactacion
Load holding valve	Lasthalteventil	Soupape de maintien de charge	Válvula de retención de carga

ELECTRICAL DIAGRAM

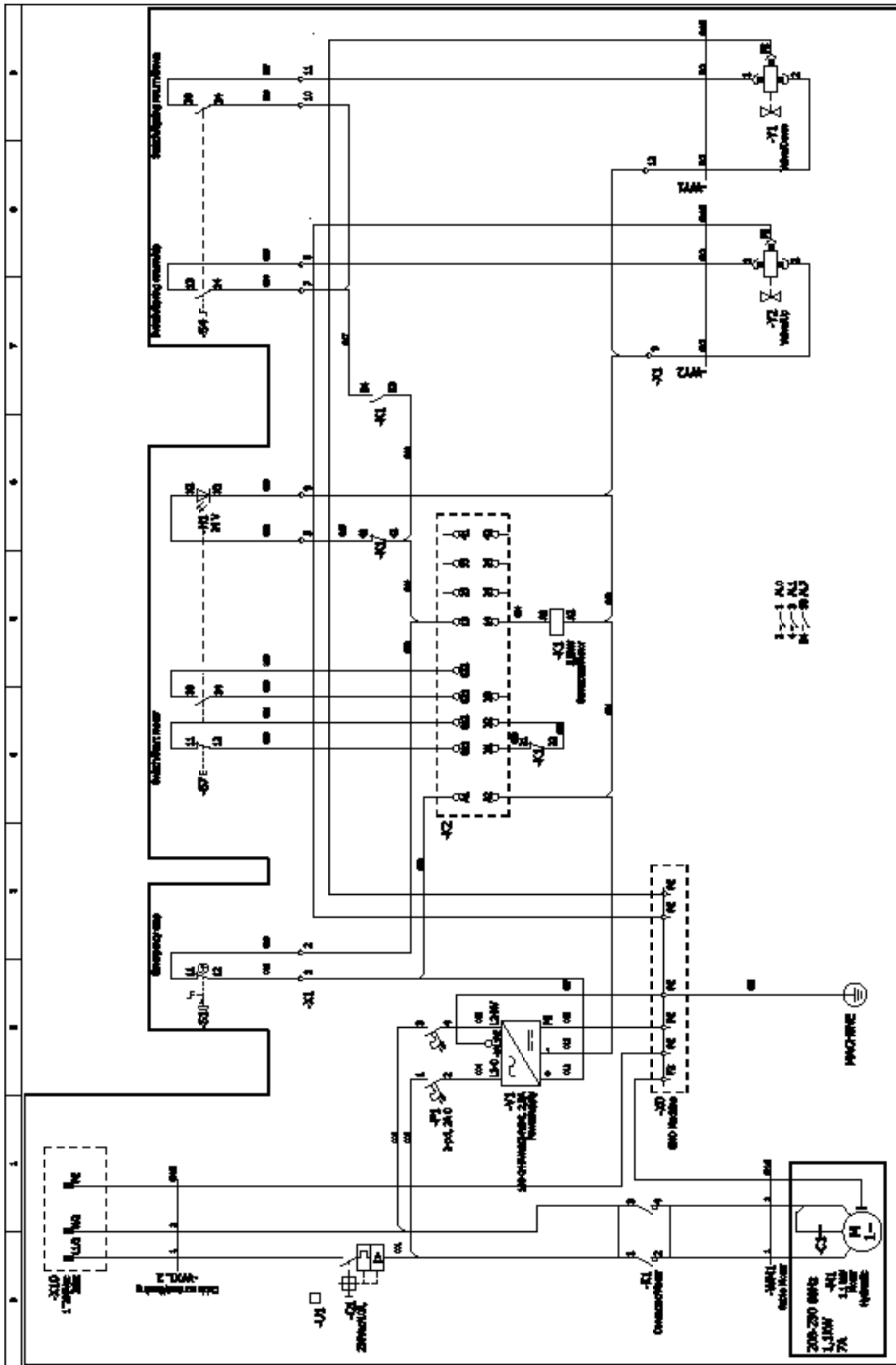

ORWAK <small>Part of ELECRO</small>	Description: 1220V/230V Included in document: 116 Sheet description: Circuit diagram
Drawn: 2024-11 Checked: [] Approved: [] Date: []	From serial number: [] Schema number: 6879674-00 Sheet: 4 of 4

ELECTRICAL DIAGRAM

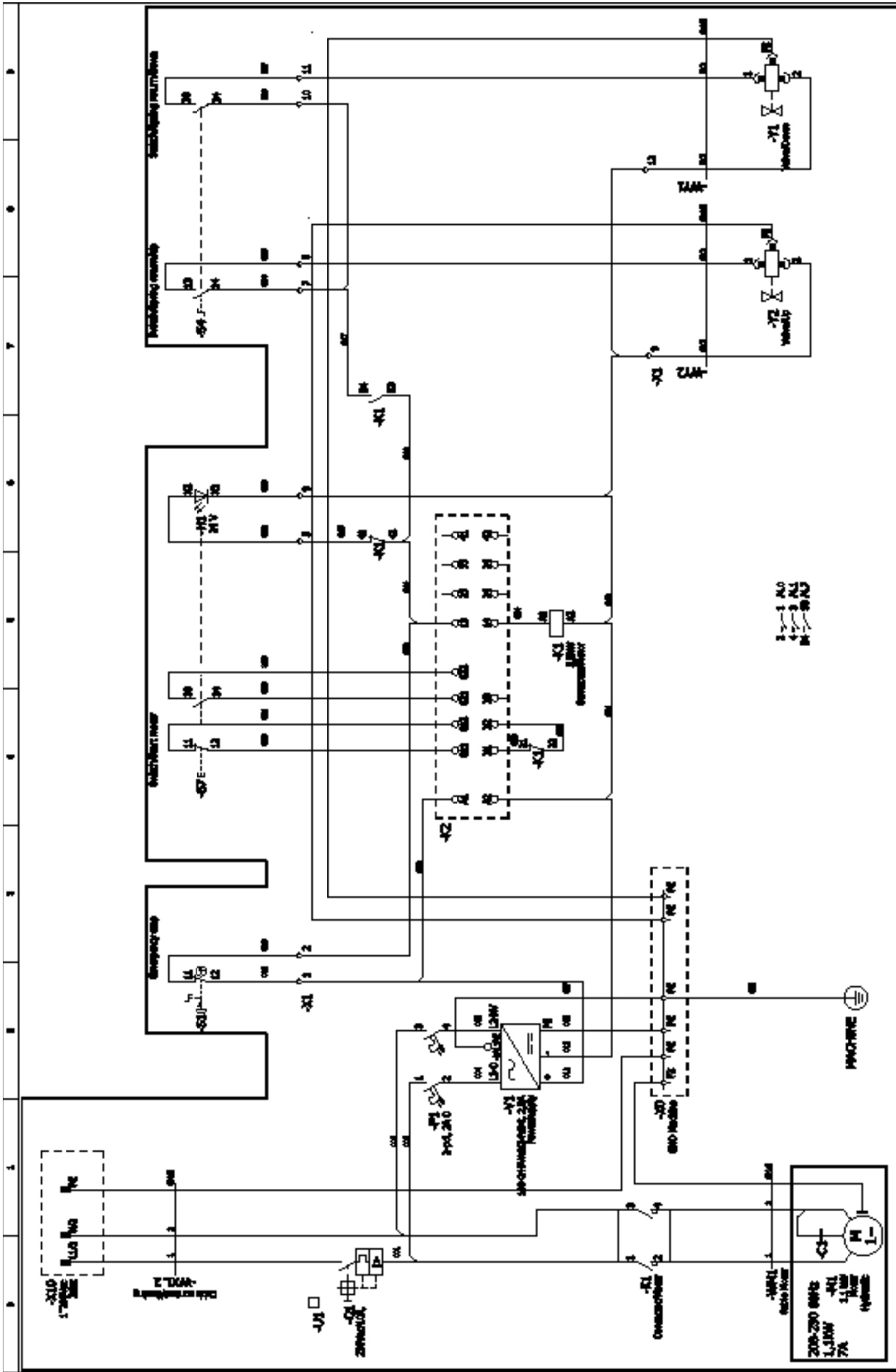

	From serial number Exchange number: 4679674-00
	Description: 14230Y/04Y Included in document: 118 Sheet description: CIRCUIT diagram
	ORWAK <small>Part of ELECEN Group</small>
	Part number: 200-230-1 Date: 2007 Checked: 2007 Drawn: 2007
	Title: 200-230-1 Date: 2007
	Scale: 1:1 Unit: mm
	Revision: 1 Date: 2007
	Sheet number: 4 Total sheets: 4

COMPACTION SOLUTIONS FOR MOST TYPES OF WASTE

ORWAK develops solutions for sorting and recycling waste materials that improve business efficiency, contribute to a cleaner working and natural environment to provide the best total waste handling economy.

We offer an innovative range of products that promotes sorting at source and make waste management more profitable.

ORWAK AB
Svetsaregatan 4
S-57622 Sävsjö
SWEDEN
Tel: +46-(0)382-15700
info@orwak.com

ORWAK.COM

 **ORWAK**[®]
PART OF **SULO** GROUP